

# ASSEMBLY INSTRUCTIONS

## Power V™ *Inversion Table*

Patent applies.

### PRE-ASSEMBLY

**Before you begin:** These instructions will guide you in properly assembling the unit. Please review all the steps before beginning assembly. Carefully adhere to the Assembly Instructions and Owner's Manual to help ensure user security and product integrity.

### ⚠ WARNING

1. It is your responsibility to familiarize yourself with the proper use of the equipment and the inherent risks of inversion, such as falling on your head or neck, pinching, entrapment or equipment failure.
2. This product is not designed for persons over 6ft 6in (198 cm) or 300 lbs (136 kg). Structural failure could occur or head/neck may impact floor during inversion. Serious injury or death could result.
3. DO NOT use the equipment without a licensed physician's approval and a review of the medical contraindications, as noted in the Owner's Manual.
4. Failure to assemble and/or use the equipment as directed may void the manufacturer's warranty on this product and could result in injury or death.
5. DO NOT use the inversion table until you have thoroughly and carefully read the Owner's Manual, reviewed all other accompanying documents, and inspected the equipment.
6. This product requires a grounded outlet. Improper connection to a 3-prong grounded outlet can result in electrical shock.
7. Choose a level surface for assembling and operating the table.
8. Follow each step in sequence. Do not skip ahead.
9. Make sure that all fasteners are secure.
10. PRIOR TO USE, test and inspect the table. Make sure that the table rotates smoothly to the inverted position and back.
11. Replace defective components immediately and/or keep the equipment out of use until repair.
12. Refer to additional warning notices and information posted on the equipment.

Carefully remove the individual parts from the carton. You should have all of the items listed below. If any items are missing or damaged, contact your retailer or customer service directly (See reverse side).

#### ITEMS FOR ASSEMBLY

#### ITEM #'s

|                      |         |
|----------------------|---------|
| Bed Frame            | P1-6000 |
| A-Frame              | P1-1005 |
| A-Frame Locking Knob | P1-1004 |
| Main Shaft           | P1-6002 |
| Locking Knobs (2)    | P1-1003 |
| Screws (4)           | H1-1603 |
| Wrench               | P1-6005 |
| Handles (2)          | P1-2003 |

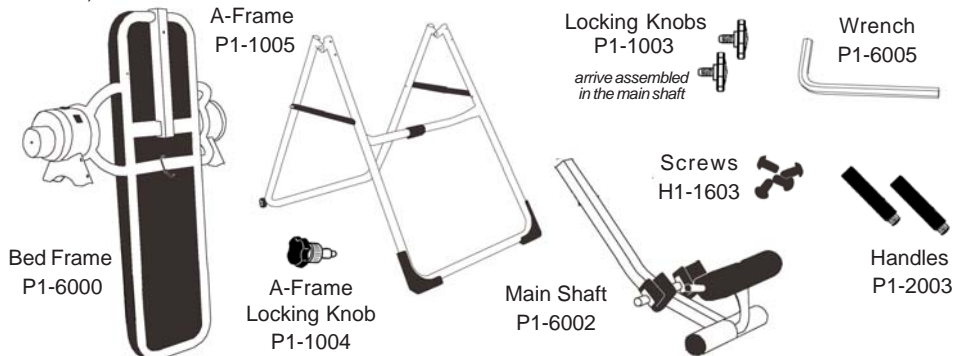

### ASSEMBLY

**Note:** The Bed Frame arrives rotated into the fully inverted position. This is the most convenient position from which to begin the assembly process.

#### STEP ONE

##### Attach the Bed Frame (P1-6000) to the A-Frame (P1-1005)

- Open the A-frame and make sure that the spreader arms are locked flat.
- Lift the Bed Frame (the bed mat will be facing the rear) and place the shrouds over the top of the A-Frame legs (See Figure 1).  
**WARNING: The Bed Frame weighs 50 lbs. If you are unsure of your ability to comfortably lift this weight, please seek assistance with assembling this product.**
- Make sure the Bed Frame rests evenly on the A-Frame and that the holes are aligned.
- Insert and tighten the Screws (H1-1603) into the shrouds on both sides of the Bed Frame using the Wrench provided (See Figure 2).

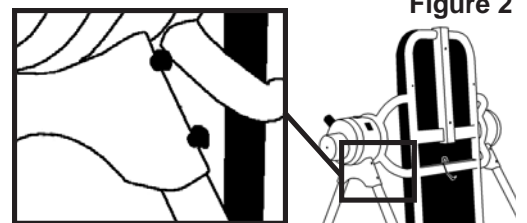
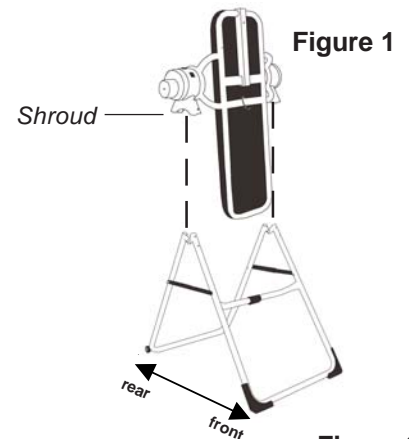

### ⚠ WARNING

Ensure the Bed Frame is securely attached to the A-frame and that the A-frame sits evenly on the floor. Improper assembly could cause serious injury or death.

# ASSEMBLY

## STEP TWO

### Secure the A-Frame Locking Knob (P1-1004)

- Hand-tighten the A-Frame Locking Knob into the A-Frame Locking Knob housing located on the side of the A-Frame opposite of the Rotation Control and Foot Clamp Buttons. (See Figure 3)

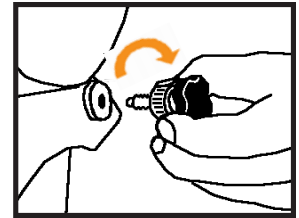

Figure 3

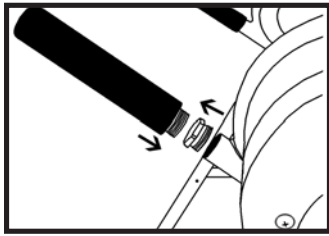

Figure 4

## STEP THREE

### Attach the Handles (P1-2003)

- Remove the pre-assembled shipping screws in the Handle arms and discard.
- Insert and screw in the Handles into the arms of both sides of the Bed Frame (See Figure 4).

## STEP FOUR

### Secure the Main Shaft (P1-6002) to the Bed Frame (P1-6000)

- Insert the Main Shaft into the Bed Frame (See Figure 5).
- Line up the holes on the back of the bed with those on the Main Shaft. Insert and hand-tighten both Locking Knobs (P1-1003) to secure the Main Shaft to the Bed Frame.

Figure 5

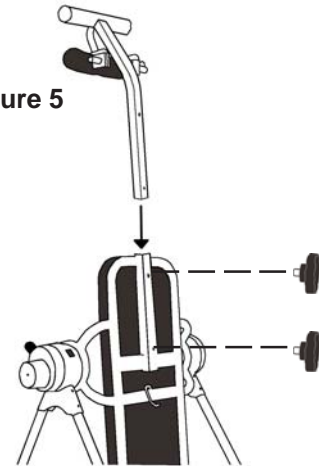

## WARNING

Failure to secure the Locking Knobs could cause your head to impact the floor, resulting in serious injury or death.



Figure 6

## STEP FIVE

### Connect cord to the power source

- Attach the power cord on the Bed Frame to the receptor at the end of the Main Shaft (See Figure 6).
- Connect the power source cord to an outlet. Rotate the Bed upright (See Figure 7) using the Rotation Control Button (the button toward the rear of the table).
- Push the Ankle Clamp Adjustment Button to ensure the Front Clamps operate smoothly. If there is a failure of one or both buttons, or the parts do not operate smoothly, there is a malfunction and you should contact customer service.

Figure 7



### GROUNDING INSTRUCTIONS

This product must be grounded. If it should malfunction or breakdown, grounding provides a path of least resistance for electric current to reduce the risk of electric shock. This product is equipped with a cord having an equipment-grounding conductor and a grounding plug. The plug must be plugged into an appropriate outlet that is properly installed and grounded in accordance with all local codes and ordinances.

DANGER - Improper connection of the equipment-grounding conductor can result in a risk of electric shock. Check with a qualified electrician or serviceman if you are in doubt as to whether the product is properly grounded. Do not modify the plug provided with the product - if it will not fit the outlet, have a proper outlet installed by a qualified electrician.

## STEP FIVE

### You have completed assembly of the Power V™ Inversion Table.

- Read your Owner's Manual thoroughly before using the inversion table.
- For your reference, the table's serial number can be found on a sticker mounted to the motor housing.



Patent applies.

Teeter Hang Ups® is a registered trademark of STL International, Inc. and Inversion International, Ltd. Specifications subject to change without notice.

© COPYRIGHT 2006, STL International, Inc. and Inversion International, Ltd.  
International Law Prohibits Any Copying, 10/06-2

For information about the Teeter Hang Ups® 2-year warranty, to order replacement labels or manuals, or if you have any problems assembling the equipment or questions about its use, please contact Customer Service at the appropriate location below:

#### USA & Canada:

STL International, Inc.  
9902 162<sup>nd</sup> St. Ct. E.  
Puyallup, WA 98375  
(Phone) 800-847-0143  
(Fax) 800-847-0188  
(email) Info@STLIntl.com  
(web) www.STLIntl.com

#### International:

Inversion International, Ltd.  
PO Box: AP 59245  
New Providence Island, Bahamas  
(Phone) +1-242-362-1001  
(Fax) +1-242-362-1002  
(email) Info@InversionInternational.com  
(web) www.InversionInternational.com

#### Europe:

Teeter Ltd.  
Cygnet House, Sydenham Road  
Croydon, Surrey CR0 2EE, UK  
(Phone) +44-(0)20-8667-0060  
(Fax) +44-(0)20-8680-3999  
(email) mail@TeeterLtd.com  
(web) www.TeeterLtd.com